

Jamboard

Installation Guide Floor Stand

**WARNING: DO NOT CLEAN JAMBOARD
WITH ANY LIQUID SOLVENTS**

Floor Stand Installation Parts

Floor Stand Box

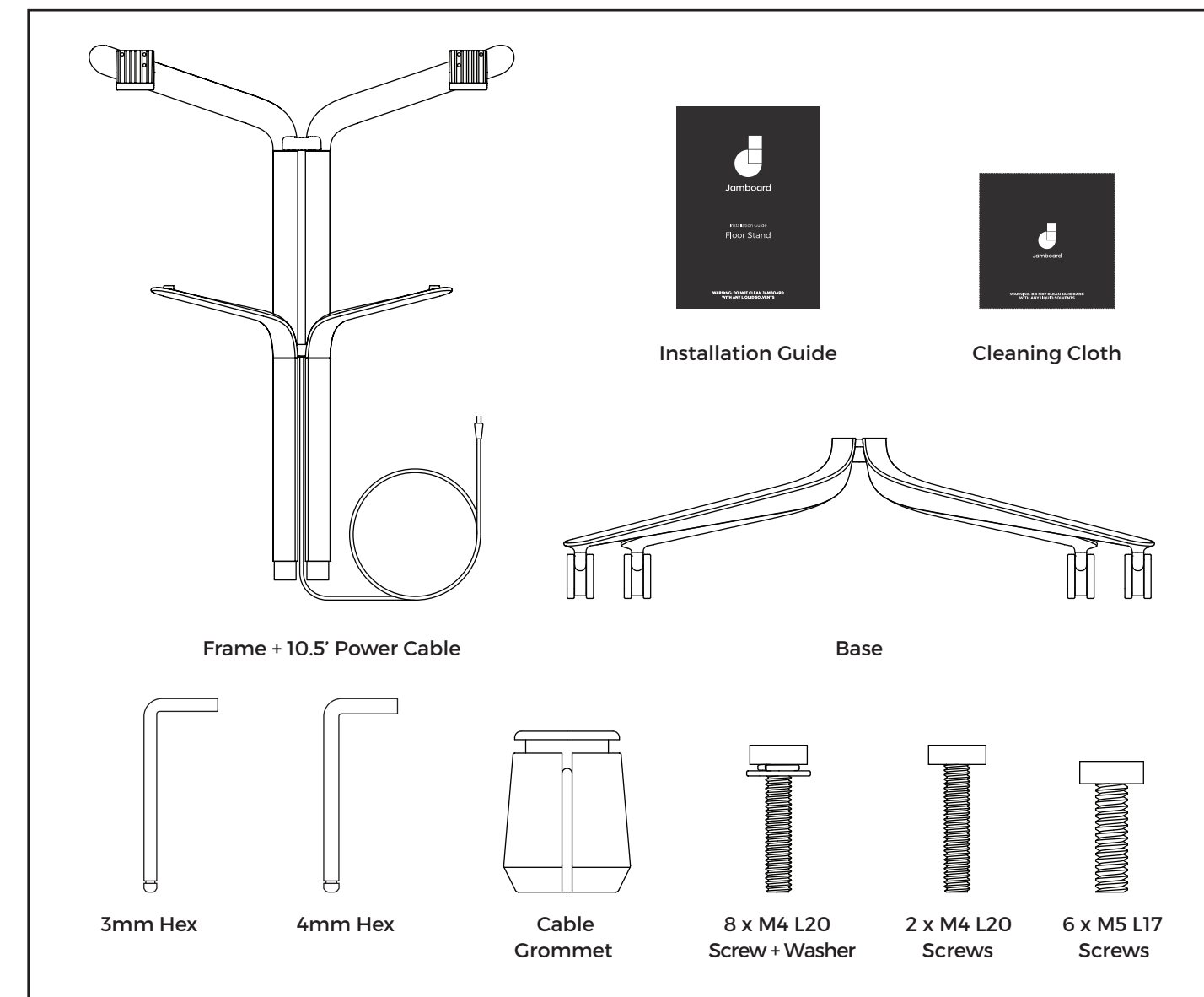

Display and Wall Mount Box

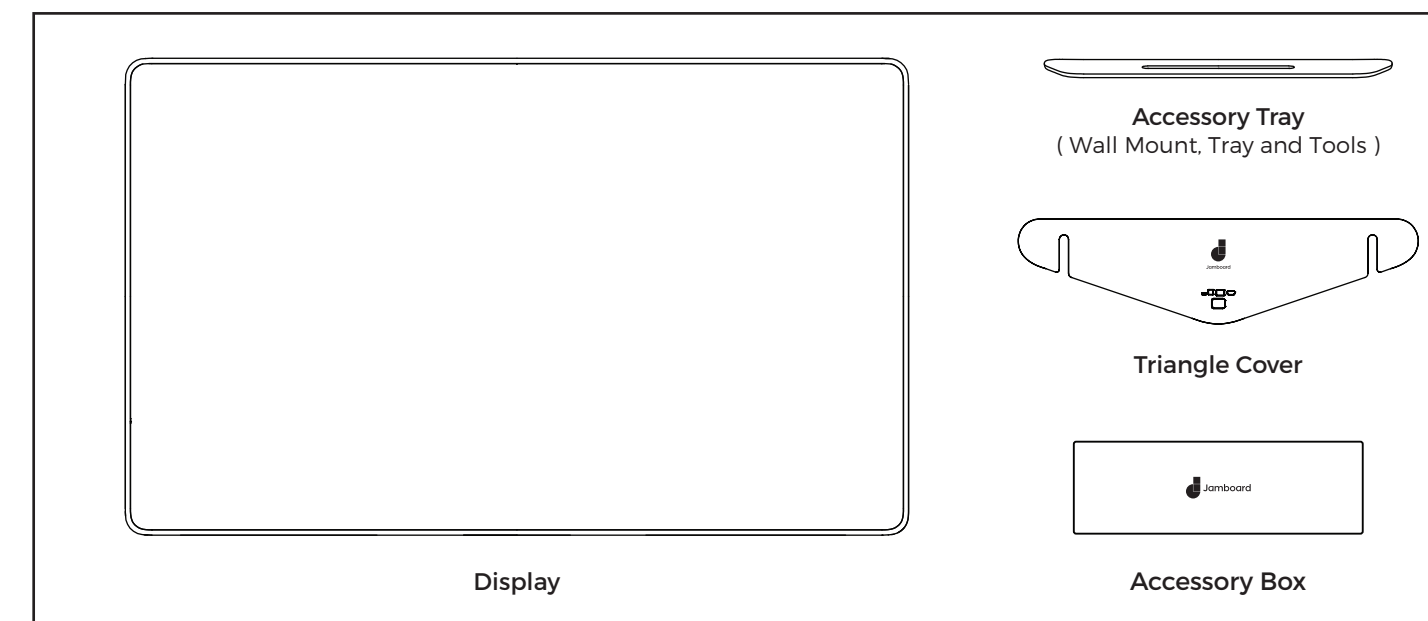

1 Attach frame and power cable to base

⚠ The longer legs should face forward

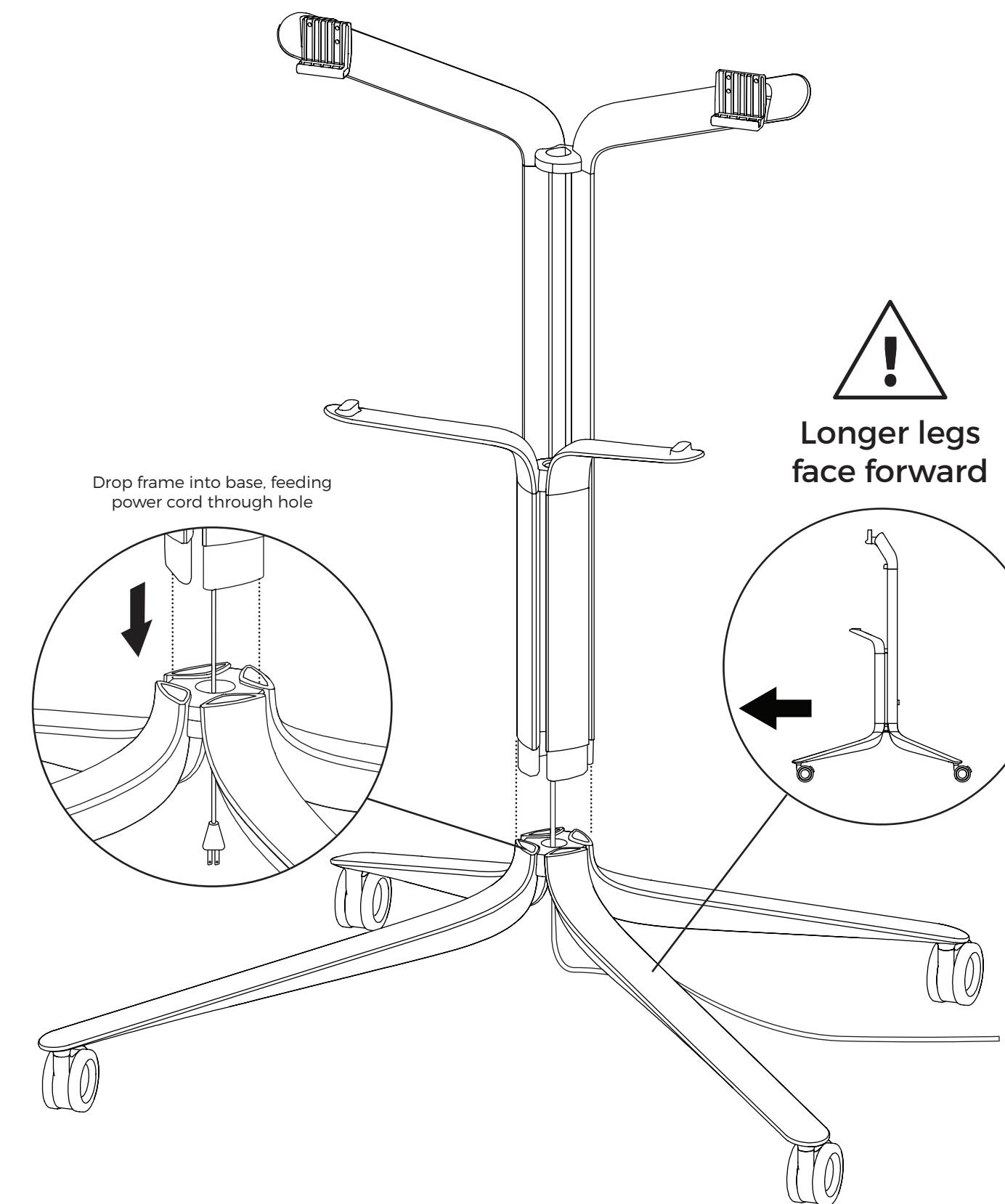

2 Secure frame to base with 8 x M4 Screws

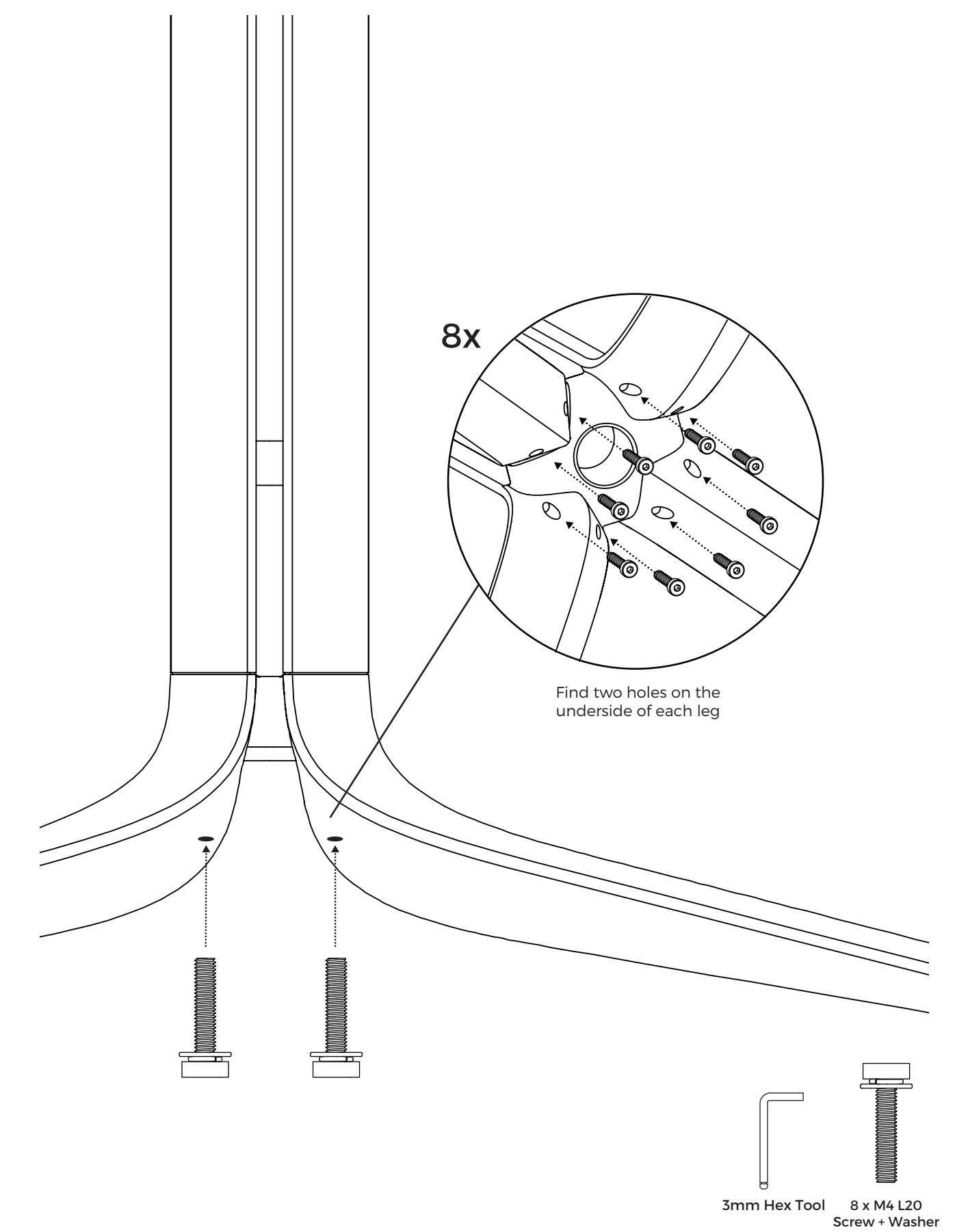

3 Slide cable grommet along power cord up into base

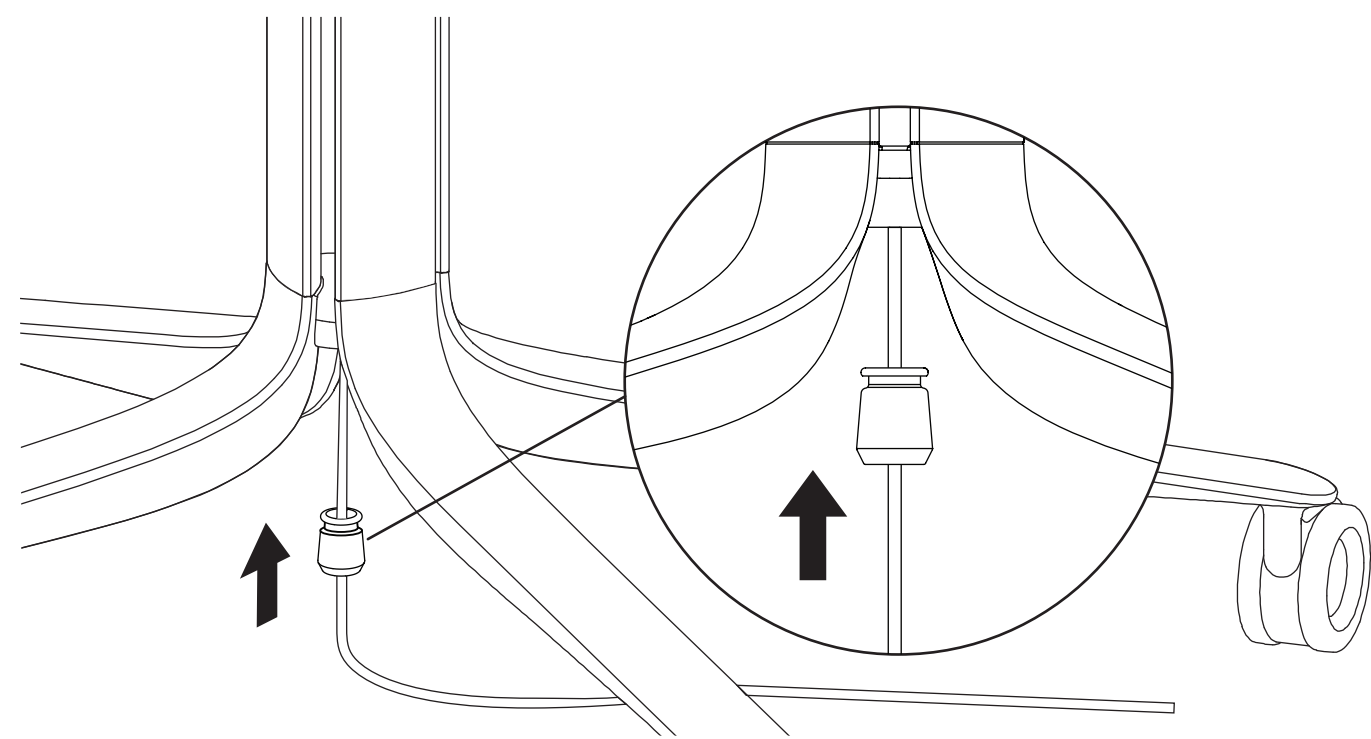

4 Mount tray to arms via 2 x M4 screws

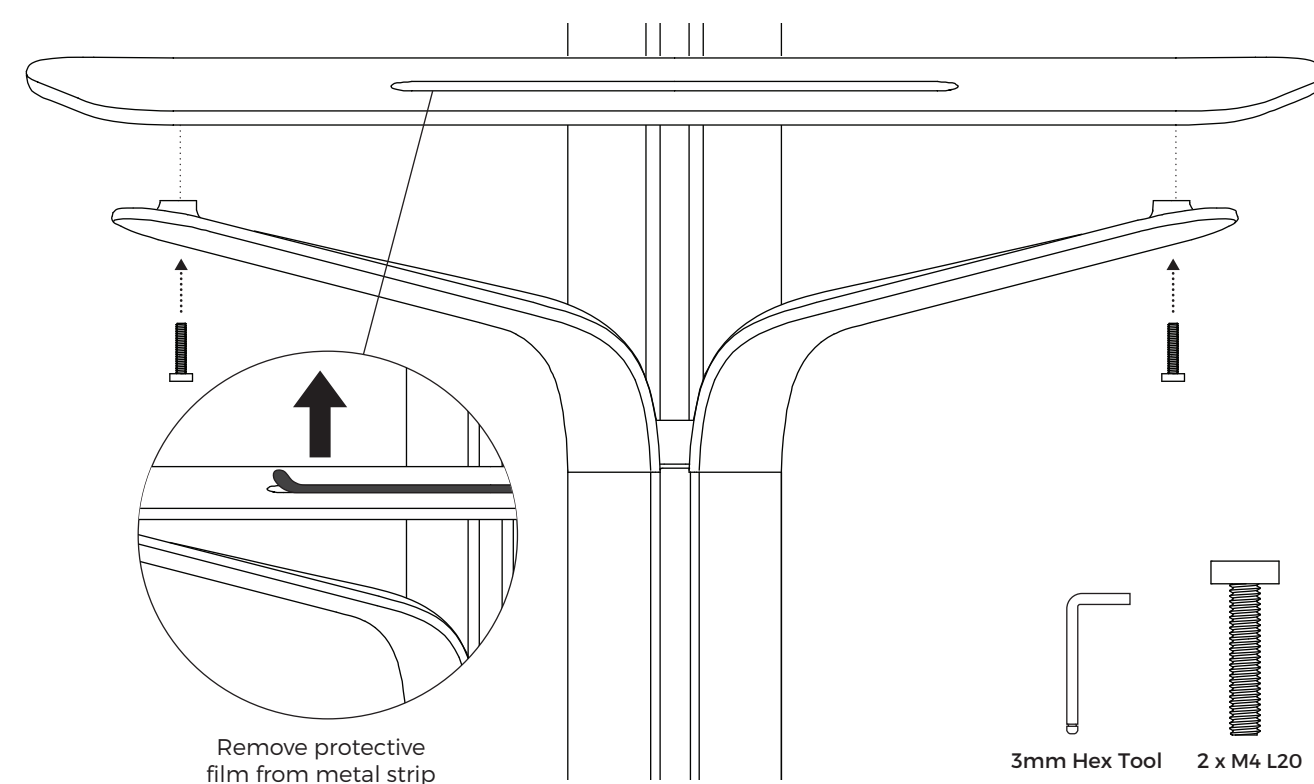

5 Attach the display to frame via mounting arms

⚠ This assembly step requires minimum 2 people

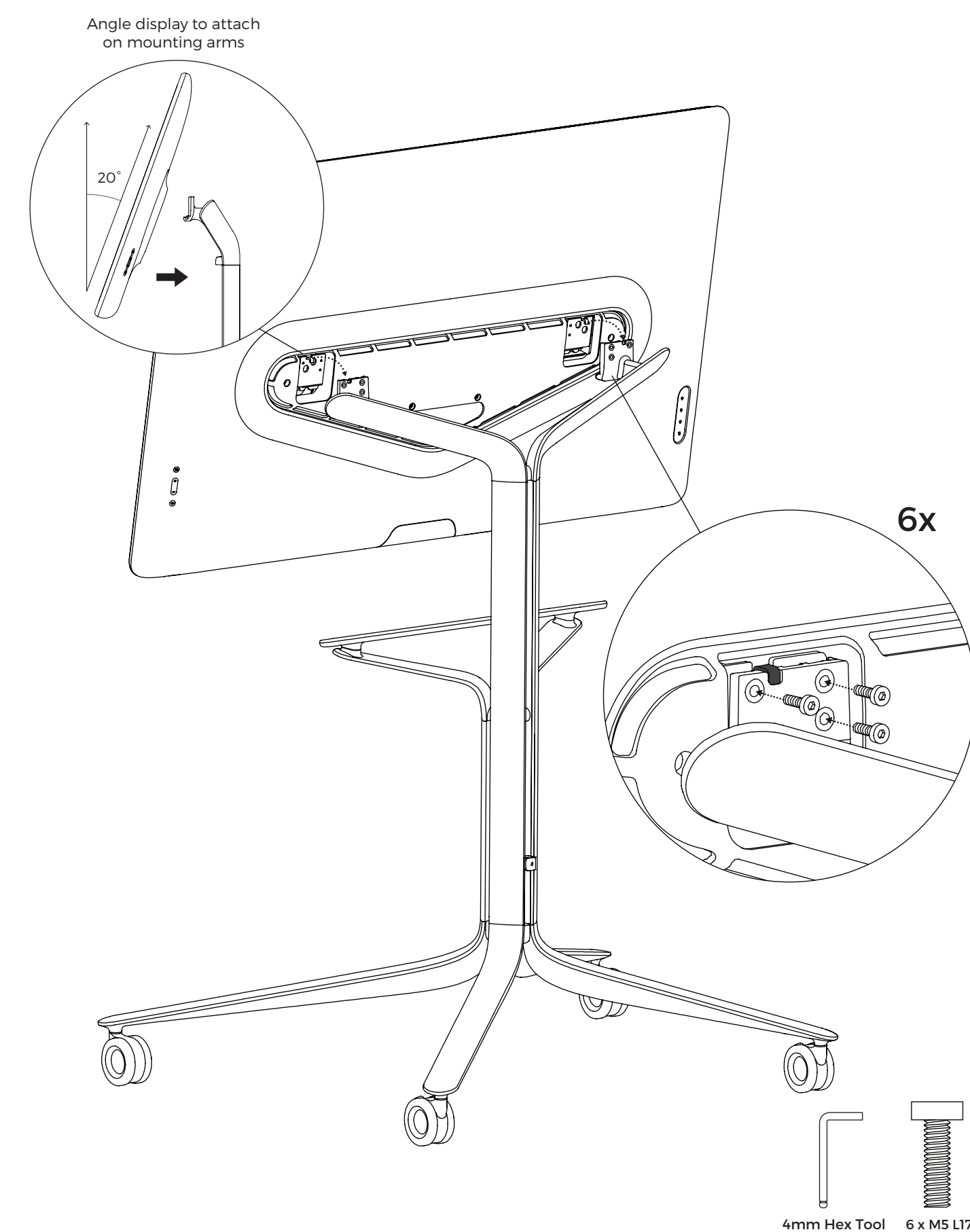

6 Attach triangle cover with embedded magnets

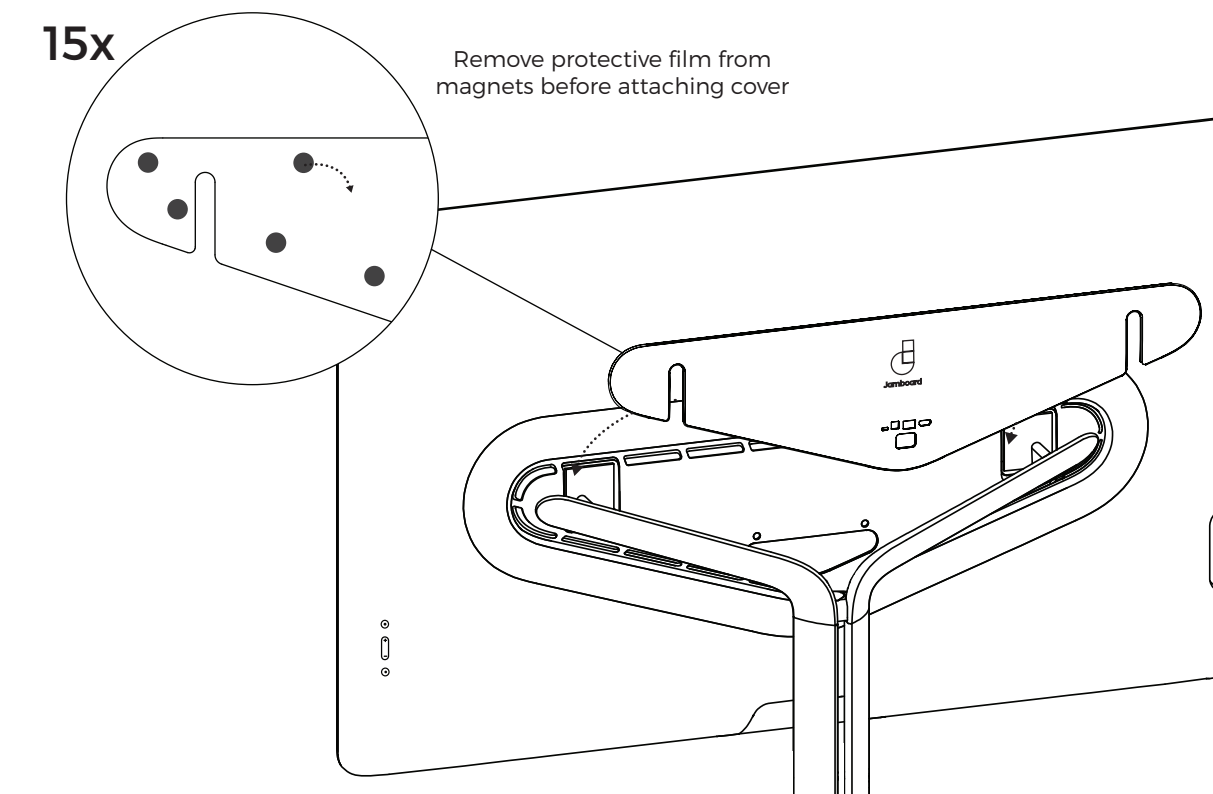

7 Place accessory box on tray

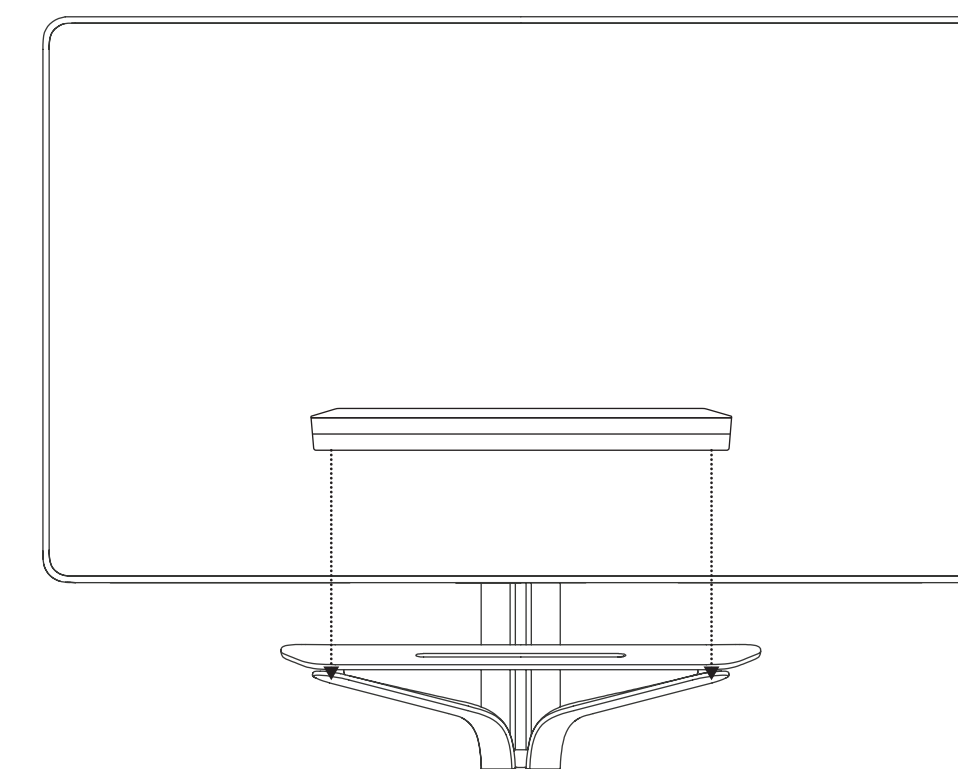

**WARNING:
DO NOT CLEAN JAMBOARD
WITH ANY LIQUID SOLVENTS**

